

User Instructions ClimaRad Fan

What is the purpose of a ClimaRad Fan?

ClimaRad Fans are often installed in bathrooms, kitchens or toilets and are intended to extract polluted air. This could be, for example, humid air, cooking vapours or unpleasant smells.



ClimaRad Fan

Bedrooms and 'wet rooms' (bathroom, kitchen, toilet) are vented through window vents for the supply of fresh air and a fan for the extraction of polluted air. A flow of air through the various bedrooms is achieved via doors (an open door or under the door). To achieve a good ventilation the window vents should be open when you are in the room.

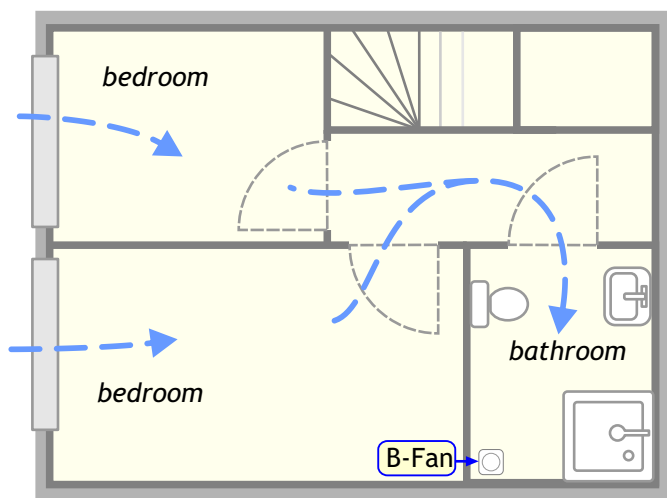

Example

Depending on the type of fan (bathroom, kitchen, toilet) the ventilation is automatically switched on, for example, when you enter the room, due to humidity in the air or if the air quality is insufficient.

The bedroom floor is ventilated in the evening and at night.

- If you have a ClimaRad 2.0 in the living room, the fan is wirelessly linked to the ClimaRad 2.0. The fan will then be automatically activated between 8 pm and 8 am.
- If you do not have a ClimaRad 2.0 in the living room, the ClimaRad Fan is operated by the CO₂ sensor or the 4-position switch.

The CO₂ sensor operates automatically. The 4-position switch can be operated by you.

Operation of ClimaRad Fan:

Automatic:

via the external CO₂-sensor
(optional)
(standard setting; 1.000 ppm)



CO₂-sensor

Manual:

via the 4-position switch
(optional)

Position I: Low
Position II: Medium
Position III: High
Auto: Automatic



4-position switch