

# Maintenance Instructions ClimaRad 1.1

## Maintenance frequency for filters

### When should you replace the filters?

- With normal use, every 2 years or earlier if the message 'Filter vervuild' appears on the display (for example in homes and offices).
- In the case of intensive use, after 1 year or earlier if the message 'Filter vervuild' appears on the display (e.g. for care homes and schools).

### Ordering filters

Order new filters at

[www.climarad.nl/filters](http://www.climarad.nl/filters)

## Replacing air supply filters

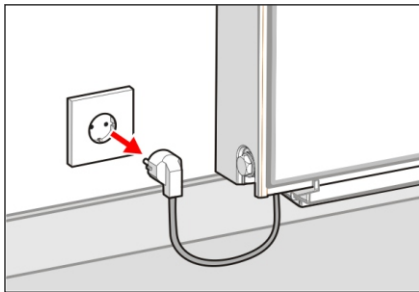

1. Switch off the device first by removing the plug from the socket.

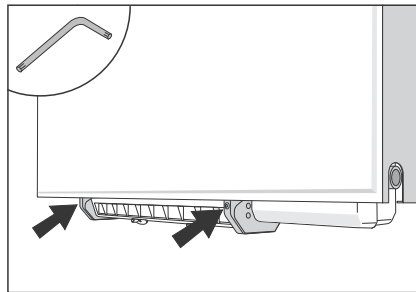

2. Turn the two locking pins outwards with an Allen key.

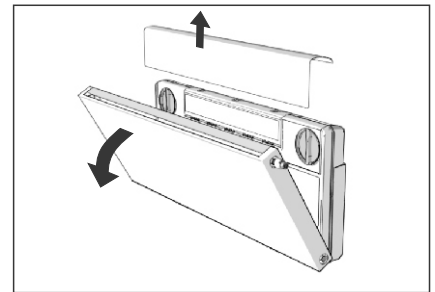

3. Tilt the radiator as far forward as possible and remove the cover.

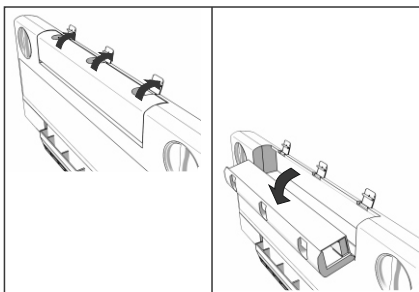

4. Open the three clips on the top and tilt the filter housing until it is open.

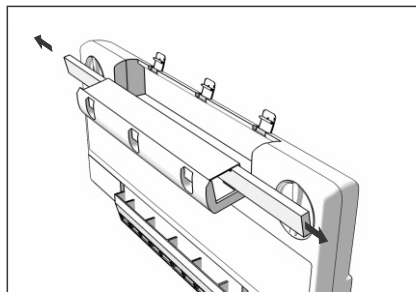

5. Slide the two contaminated filters to the left and the right out of the filter housing.

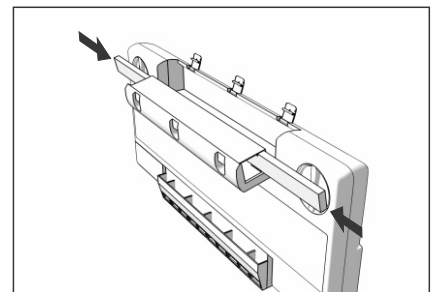

6. Slide the two new filters fully into the filter housing so that they do not project.

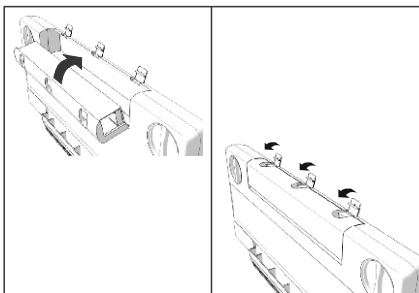

7. Tilt the filter housing close and secure with the three clips.

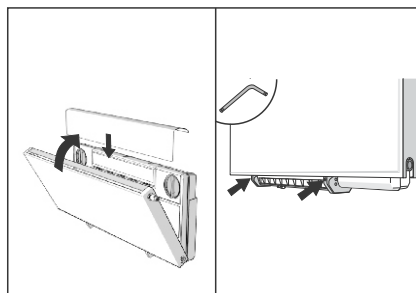

8. Install the cover and close the radiator. Then turn the two retaining pins inwards with an Allen key.

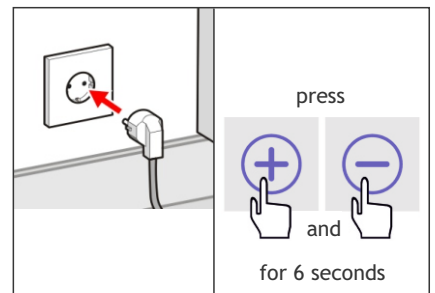

9. Push the plug back into the socket and reset the filter hour counter by simultaneously pressing on the + and - on the display for 6 seconds. The message 'Filter vervuild' will disappear.

**Important:** Reset the filter hour counter only if you have replaced the filters.

## Cleaning the filter tray

The filter tray is located at the bottom of the device. Regularly check whether the filter tray is dirty.

Vacuum the tray when dirty. You do not need to remove the air outlet filter.

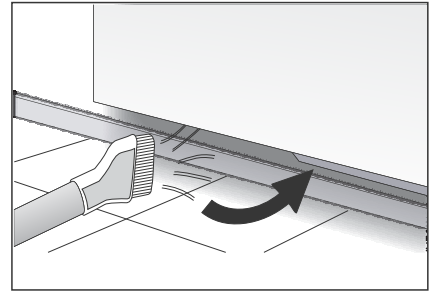

## Replacing the air outlet filters

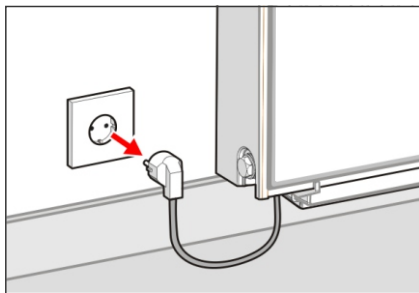

1. Switch off the device first by removing the plug from the socket.

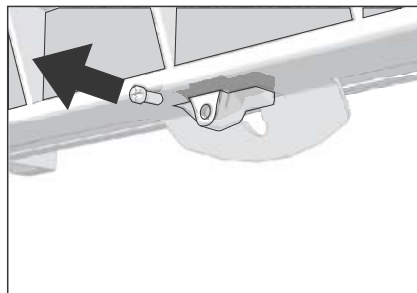

2. Loosen the two screws under the filter cover.

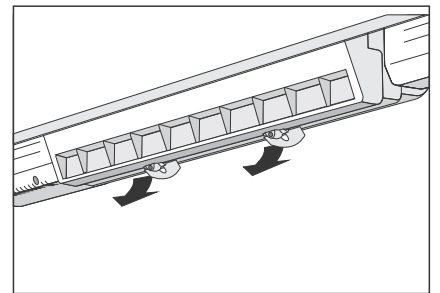

3. Pull the two clips gently towards you. Tilt the filter grille as far forward as possible.

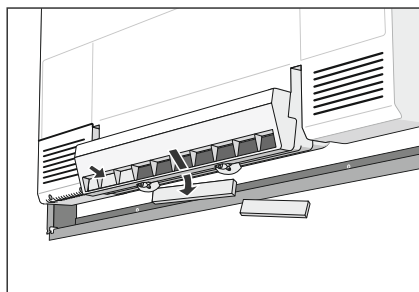

4. Push the three filters backwards so that they can come loose.

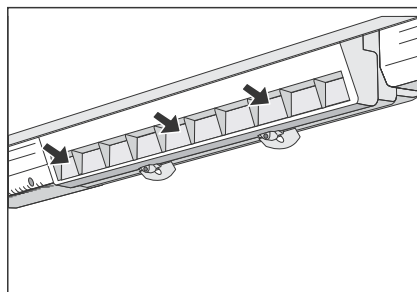

5. Place the three new filters in the sections.

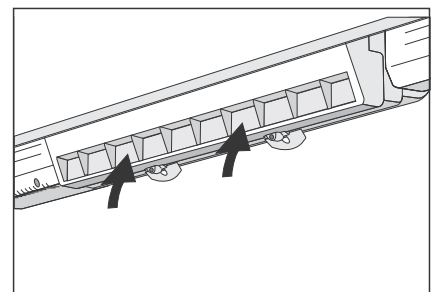

6. Press the grille at the bottom with the two clips firmly closed until you feel it snap.

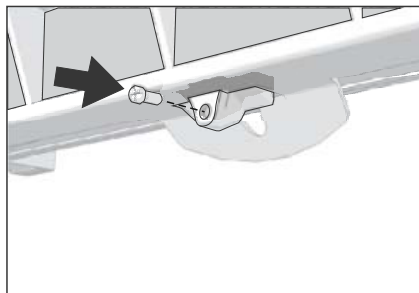

7. Screw the grille in position with the two screws.

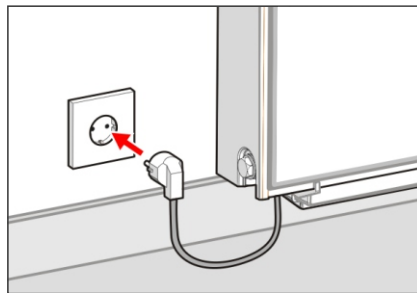

8. Push the plug back into the socket.

Please note that the grid must be properly closed for proper operation.

## Cleaning the air ducts

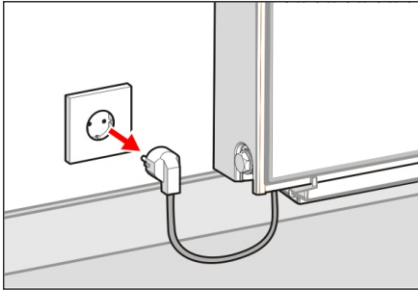

1. Switch off the device first by removing the plug from the socket.

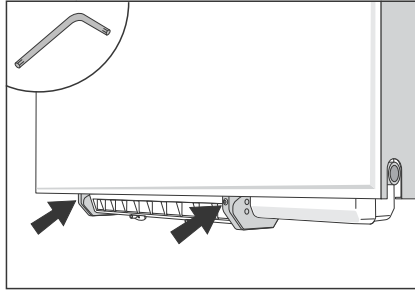

2. Turn the two locking pins outwards with an Allen key (not included).

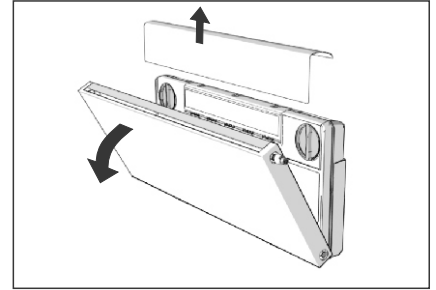

3. Tilt the radiator as far forward as possible and remove the cover.

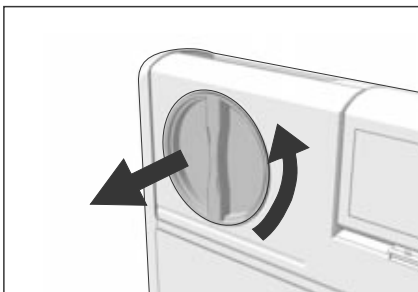

4. Remove both plugs by turning them once anticlockwise.

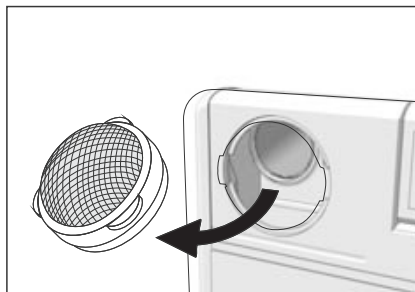

5. Grasp the round cups at the three tabs and remove.

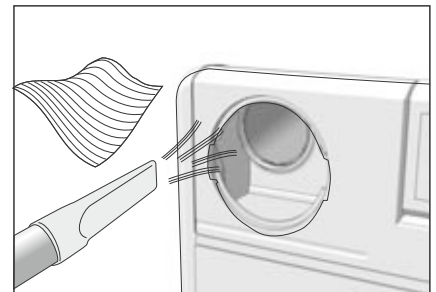

6. Remove the dirt from both channels with a vacuum cleaner or a soft cloth (do not use water).

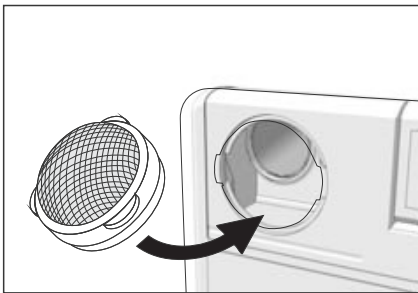

7. Insert the round cups.

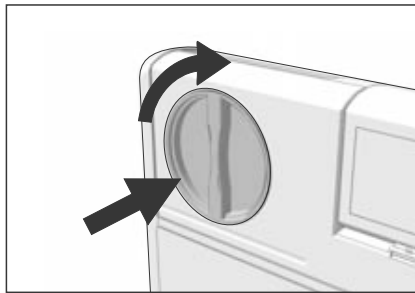

8. Replace both plugs and tighten them properly until closed.

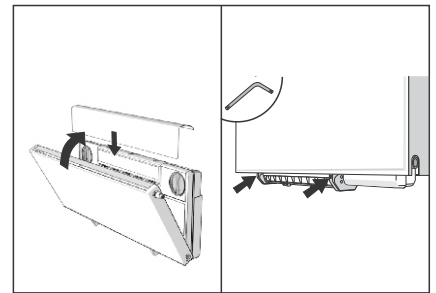

9. Install the cover and close the radiator. Then turn the two retaining pins inwards with an Allen key.

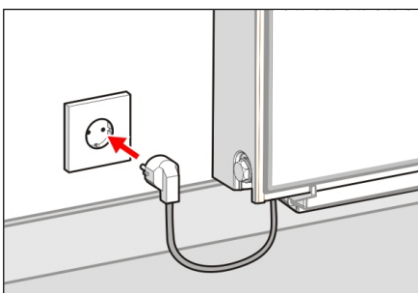

10. Push the plug back into the socket.